

HRPL

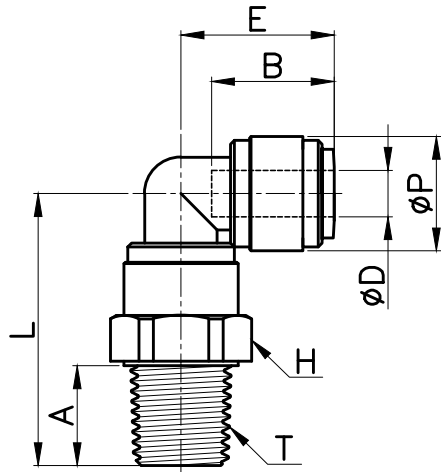

MODEL	ØD	ØP	T(BSPT,R)	A	B (TUBE DEEP)	E	H (Hex)	L	WEIGHT (g)	EA (box)
HRPL 04R01	04	13.2	1/8	9.1	14.7	17.9	15.0	29.7	5.9	50
HRPL 04R02			1/4	13.1			17.0	33.7	7.3	50
HRPL 06R01	06	15.0	1/8	9.1	16.1	20.1	17.0	31.7	7.2	50
HRPL 06R02			1/4	13.1			17.0	35.7	8.0	50
HRPL 08R01	08	17.6	1/8	9.1	17.5	21.9	19.0	33.4	9.9	25
HRPL 08R02			1/4	13.1			19.0	37.4	10.7	25
HRPL 08R03			3/8	13.5			19.0	37.8	11.4	25
HRPL 10R02	10	20.0	1/4	13.1	20.1	25.8	21.0	41.4	15.1	25
HRPL 10R03			3/8	13.5			21.0	41.8	15.2	25
HRPL 10R04			1/2	16.5			24.0	44.8	19.5	20
HRPL 12R03	12	23.0	3/8	13.5	24.7	31.7	24.0	48.2	23.4	20
HRPL 12R04			1/2	16.5			24.0	51.2	25.9	20