



 -198°C ÷ +648°C  
-28°C ÷ +204°C (1449)

 **Working pressure:**  
See the table for each code.  
The pressure was calculated at 37.8 °C.

 Compressed air, water and fluids suitable with construction materials

-  - Taper gas BSPT ISO 7 from R1/8" to R1"
-  - Parallel gas BSPP ISO 228 from G1/8" to G1-1/2"
- NPT from N1/8" to N1"

 **Body:** Stainless steel AISI 316  
**O-ring:** Viton (1449)

 Food contact materials EC 1935/2004

 D.M. 174  
D.M. 174/2004

 **REACH** COMPLIANT  
Products in compliance with EC Regulation 1907/2006

 **RoHS3**  
Products in compliance with the directive EU 2015/863

**CONSTRUCTION DETAILS**

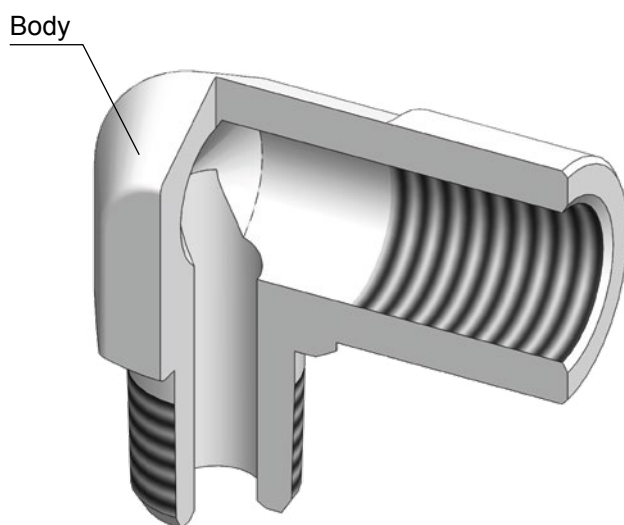

**P-SL**

## Female elbow BSPP thread

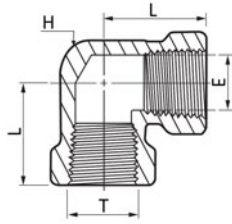

CODE	T	L	E	H	PN (Bar)
P-SL-2G	G 1/8"	24,1	8,9	12,7	448
P-SL-4G	G 1/4"	29,0	11,7	17,5	455
P-SL-6G	G 3/8"	34,5	15,0	20,6	365
P-SL-8G	G 1/2"	37,0	18,7	25,4	338
P-SL-12G	G 3/4"	46,5	23,5	31,8	317
P-SL-16G	G 1"	48,8	29,7	42,9	303

**P-SSL**

## Male elbow BSPT thread &amp; female BSPP thread

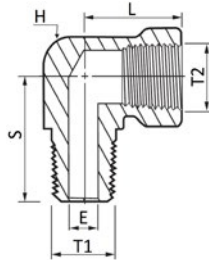

CODE	T1	T2	E	L	S	H	PN (Bar)
P-SSL-2GR	R 1/8"	G 1/8"	4,8	24,1	19,6	12,7	448
P-SSL-4GR	R 1/4"	G 1/4"	7,1	29,0	26,5	17,5	455
P-SSL-6GR	R 3/8"	G 3/8"	9,6	34,5	28,2	20,6	365
P-SSL-8GR	R 1/2"	G 1/2"	11,9	37,0	35,3	25,4	338
P-SSL-12GR	R 3/4"	G 3/4"	15,7	46,5	39,6	31,8	317
P-SSL-16GR	R 1"	G 1"	22,3	48,8	49,2	42,9	303

**P-ST**

## Female tee BSPP thread

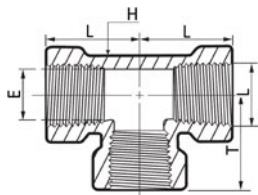

CODE	T	E	L	H	PN (Bar)
P-ST-2G	G 1/8"	8,9	24,1	12,7	448
P-ST-4G	G 1/4"	11,7	29,0	17,5	455
P-ST-6G	G 3/8"	15,0	34,5	20,6	365
P-ST-8G	G 1/2"	18,7	37,0	25,4	338
P-ST-12G	G 3/4"	23,5	46,5	31,8	317
P-ST-16G	G 1"	29,7	48,5	42,9	303

**P-SBT**

## Male tee BSPT thread &amp; female BSPP thread

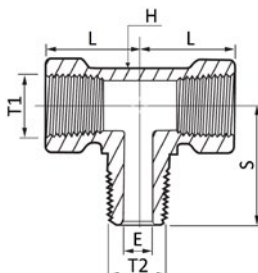

CODE	T1	T2	E	L	S	H	PN (bar)
P-SBT-2GR	G 1/8"	R 1/8"	4,8	24,1	19,6	12,7	448
P-SBT-4GR	G 1/4"	R 1/4"	7,1	29,0	26,5	17,5	455
P-SBT-6GR	G 3/8"	R 3/8"	9,6	34,5	28,2	20,6	365
P-SBT-8GR	G 1/2"	R 1/2"	11,9	37,0	35,3	25,4	338
P-SBT-12GR	G 3/4"	R 3/4"	15,7	46,5	39,6	31,8	317
P-SBT-16GR	G 1"	R 1"	22,3	48,8	49,2	42,9	303



**P-SHN**

## Nipple adapter NPT &amp; BSPT thread

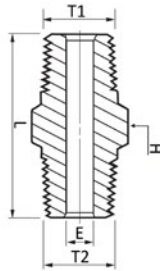

CODE	T1	T2	L	E	H	PN (Bar)
P-SHN-2NR	N 1/8"	R 1/8"	24,6	4,1	11,1	689
P-SHN-4NR	N 1/4"	R 1/4"	35,6	6,4	14,2	551
P-SHN-6NR	N 3/8"	R 3/8"	36,3	9,7	17,4	538
P-SHN-8NR	N 1/2"	R 1/2"	46,0	11,9	22,2	531
P-SHN-12NR	N 3/4"	R 3/4"	46,7	15,7	26,9	503
P-SHN-16NR	N 1"	R 1"	58,9	22,4	34,9	365

**P-MFAA**

## Adapter male BSPT thread &amp; female NPT thread

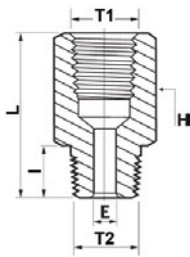

CODE	T1	T2	L	I	E	H	PN (Bar)
P-MFAA-2RN	N 1/8"	R 1/8"	27,4	9,7	4,8	14,2	448
P-MFAA-4RN	N 1/4"	R 1/4"	35,8	14,2	7,1	19,05	455
P-MFAA-6RN	N 3/8"	R 3/8"	37,6	14,2	9,7	22,2	365
P-MFAA-8RN	N 1/2"	R 1/2"	49,0	19,1	11,9	26,9	338
P-MFAA-12RN	N 3/4"	R 3/4"	50,3	19,1	15,7	31,8	317
P-MFAA-16RN	N 1"	R 1"	58,0	23,9	22,3	41,2	303

**1449**

## Male plug BSPP thread with Viton O-ring, DIN2353

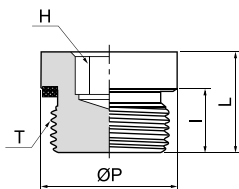

CODE	T	ØP	L	I	H	PN (Bar)
1449TRH18-V	G 1/8"	14	12,0	8	5	400
1449TRH14-V	G 1/4"	19	17,0	12	6	400
1449TRH38-V	G 3/8"	22	17,0	12	8	400
1449TRH12-V	G 1/2"	27	19,0	14	10	400
1449TRH34-V	G 3/4"	32	21,0	16	12	400
1449TRH1-V	G 1"	40	22,5	16	17	400
1449TRH114-V	G 1-1/4"	50	22,5	16	22	250
1449TRH112-V	G 1-1/2"	55	22,5	16	24	250

