

NBR: -10°C ÷ 95°C



Working pressure:
0-12 Bar (suggested)
35 Bar (max)



Compressed air



- Taper gas BSPT ISO 7
from R1/4" to R1/2"
- Parallel gas BSPP ISO 228
from G1/4" to G1/2"

FLOWRATE

NE-10: 606 l/min

AEU-75: 1086 l/min

PROFILE: EUROFLUID



CONFIGURATIONS

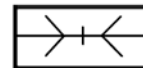

PL
Free
Passage

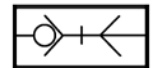

SO
Single
Shutter



Products in compliance with
EC Regulation 1907/2006



Products in compliance with
the directive EU 2015/863



COMPONENTS	EUROFLUID
Body	Nickel-plated steel
Slide	Nickel-plated steel
Adapter	Nickel-plated brass
Valve	Nickel-plated brass
Spring	Stainless steel AISI 302
Ball	Chromed steel
Retaining ring	Stainless steel AISI 302
Seal	NBR

CONNECTION	NE-10	AEU-75
Body	Hardened nickel-plated steel	Hardened nickel-plated steel

FLOW CHART

Chart created considering a working pressure of 6 Bar with a pressure drop of 0.5 Bar and simple shut-off.

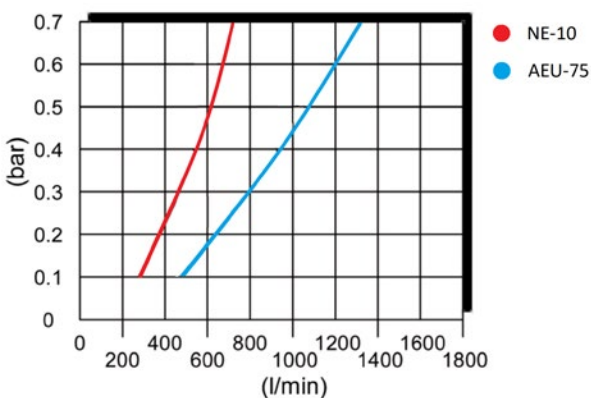

VIEW - QUICK COUPLING EUROFLUID

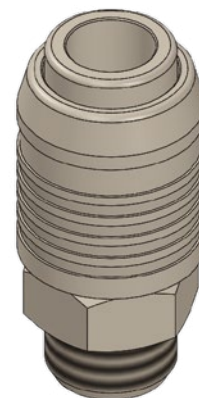

EUROFLUID-M

Male quick coupling BSPT thread

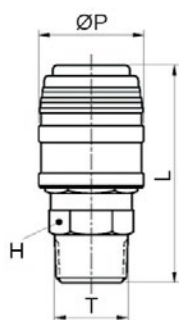

CODE	T	ØP	L	H
EUROFLUID-M1/4	R 1/4"	24,4	51,7	19
EUROFLUID-M1/4-PL	R 1/4"	24,4	51,7	19
EUROFLUID-M3/8	R 3/8"	24,4	52,7	19
EUROFLUID-M3/8-PL	R 3/8"	24,4	52,7	19
EUROFLUID-M1/2	R 1/2"	24,4	57,2	22
EUROFLUID-M1/2-PL	R 1/2"	24,4	57,2	22

Male quick coupling BSPP thread

EUROFLUID-M1/4G	G 1/4"	24,4	50,2	21
EUROFLUID-M1/4G-PL	G 1/4"	24,4	50,2	21
EUROFLUID-M3/8G	G 3/8"	24,4	51,7	21
EUROFLUID-M3/8G-PL	G 3/8"	24,4	51,7	21
EUROFLUID-M1/2G	G 1/2"	24,4	54,7	24
EUROFLUID-M1/2G-PL	G 1/2"	24,4	54,7	24

-PL: Free Passage

EUROFLUID-H

Female quick coupling BSPP thread

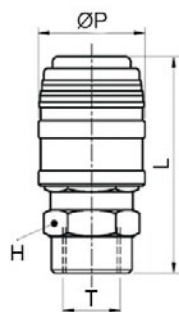

CODE	T	ØP	L	H
EUROFLUID-H1/4	G 1/4"	24,4	49,7	19
EUROFLUID-H1/4-PL	G 1/4"	24,4	49,7	19
EUROFLUID-H3/8	G 3/8"	24,4	51,2	22
EUROFLUID-H3/8-PL	G 3/8"	24,4	51,2	22
EUROFLUID-H1/2	G 1/2"	24,4	55,4	25
EUROFLUID-H1/2-PL	G 1/2"	24,4	55,4	25

-PL: Free Passage

EUROFLUID-E

Quick coupling with barb connector

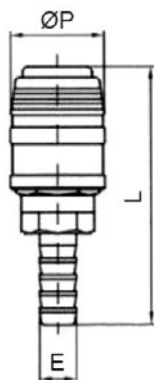

CODE	E	ØP	L	H
EUROFLUID-E6	7,2	24,4	59,2	19
EUROFLUID-E6-PL	7,2	24,4	59,2	19
EUROFLUID-E8	9,2	24,4	59,2	19
EUROFLUID-E8-PL	9,2	24,4	59,2	19
EUROFLUID-E10	11,2	24,4	63,2	19
EUROFLUID-E10-PL	11,2	24,4	63,2	19
EUROFLUID-E12	13,2	24,4	68,2	19
EUROFLUID-E12-PL	13,2	24,4	68,2	19
EUROFLUID-E13	13,8	24,4	68,2	19
EUROFLUID-E13-PL	13,8	24,4	68,2	19

-PL: Free Passage



EUROFLUID-PM

Quick coupling with push-on connector

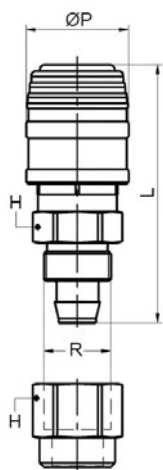

CODE	TUBE Ø	ØP	L	H
EUROFLUID-PM08	8x10	24,4	61,9	19
EUROFLUID-PM08-PL	8x10	24,4	61,9	19
EUROFLUID-PM10	10x15	24,4	66,7	22
EUROFLUID-PM10-PL	10x15	24,4	66,7	22

Recommended for use with PU-PVC tube on page 751

-PL: Free Passage**NE-10M**

Male connection BSPT thread

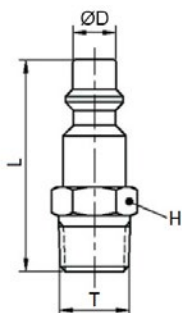

CODE	T	ØD	L	H
NE-10M	R 1/4"	8	40,0	14
NE-10M-3/8	R 3/8"	8	42,5	17
NE-10M-1/2	R 1/2"	8	46,0	22

NE-10M: Connection available in the FLUID-10N & FLUID-10S SERIES on page 569**NE-10H**

Female connection BSPP thread

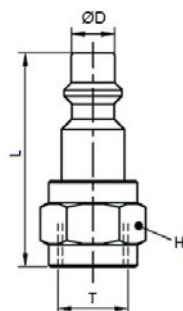

CODE	T	ØD	L	H
NE-10H	G 1/4"	8	40,0	17
NE-10H-3/8	G 3/8"	8	41,5	22
NE-10H-1/2	G 1/2"	8	44,0	25

NE-10H: Connection available in the FLUID-10N & FLUID-10S SERIES on page 569

NE-10E

Connection with barb connector

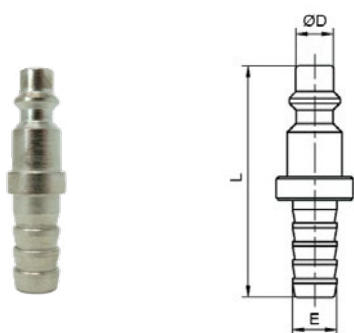

CODE	E	ØD	L
NE-10E-6	7,2	8	46,0
NE-10E-8	9,2	8	47,0
NE-10E-10	11,2	8	52,0
NE-10E-12	13,2	8	54,0

NE-10E: Connection available in the FLUID-10N & FLUID-10S SERIES on page 569

NE-10PM

Connection with push-on connector

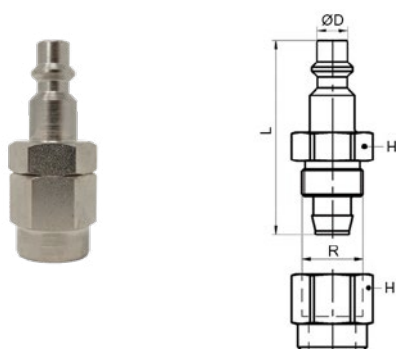

CODE	TUBE Ø	R	ØD	L	H
NE-10PM-08	8x12	M16x1	8	50,7	19
NE-10PM-10	10x15	M20x1	8	55,5	22

Recommended for use with PU-PVC tube on page 751

NE-10PM: Connection available in the FLUID-10N & FLUID-10S SERIES on page 569

AEU-75M

Male connection BSPT thread

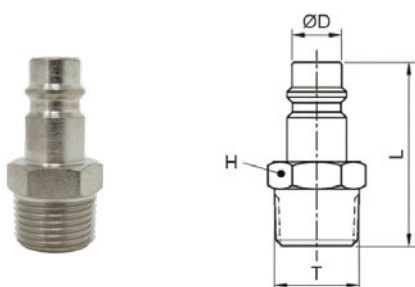

CODE	T	ØD	L	H
AEU-75M	R 1/4"	10	36,5	14
AEU-75M38	R 3/8"	10	37,0	17

AEU-75M: Connection available in the EUROSTANDARD SERIES on page 597



AEU-75H

Female connection BSPP thread

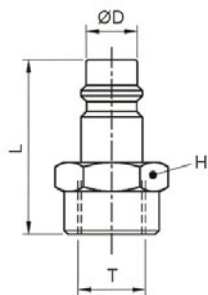

CODE	T	ØD	L	H
AEU-75H	G 1/4"	10	34,0	17
AEU-75H38	G 3/8"	10	34,5	20

AEU-75H: Connection available in the EUROSTANDARD SERIES on page 597

AEU-75E

Connection with barb connector

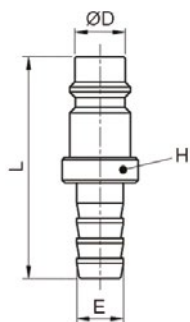

CODE	E	ØD	L	H
AEU-75E	9,2	10	44,0	15
AEU-75E10	11,2	10	48,0	15

AEU-75E: Connection available in the EUROSTANDARD SERIES on page 597

AEU-75PM

Connection with push-on connector

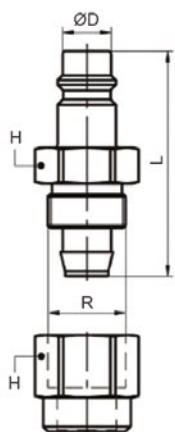

CODE	TUBE Ø	R	ØD	L	H
AEU-75PM08	8x12	M16x1	10	46,7	19
AEU-75PM10	10x15	M20x1	10	51,5	22

Recommended for use with PU-PVC tube on page 751

AEU-75PM: Connection available in the EUROSTANDARD SERIES on page 597

