

**WTRMF-G**

Bulkhead female connector BSPP thread nickel plated

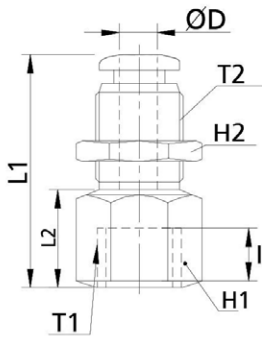

CODE	ØD	T1	T2	I	H1	H2	L1	L2	GR.
WTRMF04G01	4	G1/8"	M12X1	7,0	14	14	23,3	9,5	15,5
WTRMF04G02	4	G1/4"	M12X1	9,0	17	14	25,4	11,6	20,4
WTRMF06G01	6	G1/8"	M14X1	7,0	17	17	24,2	7,0	26,3
WTRMF06G02	6	G1/4"	M14X1	9,0	17	17	29,2	12,0	26,5
WTRMF06G03	6	G3/8"	M14X1	10,0	19	17	30,2	13,0	35,1
WTRMF08G01	8	G1/8"	M16X1	7,0	19	19	27,4	5,0	32,0
WTRMF08G02	8	G1/4"	M16X1	9,0	19	19	34,4	12,0	42,4
WTRMF08G03	8	G3/8"	M16X1	10,0	19	19	34,4	13,0	42,4
WTRMF08G04	8	G1/2"	M16X1	12,0	24	19	36,4	15,0	47,7
WTRMF10G01	10	G1/8"	M20X1	7,0	21	24	28,4	7,7	52,8
WTRMF10G02	10	G1/4"	M20X1	9,0	21	24	30,4	9,7	53,5
WTRMF10G03	10	G3/8"	M20X1	10,0	21	24	33,7	13,0	53,8
WTRMF10G04	10	G1/2"	M20X1	12,0	24	24	35,7	15,0	58,8
WTRMF12G02	12	G1/4"	M22X1	9,0	24	27	33,5	9,1	68,2
WTRMF12G03	12	G3/8"	M22X1	10,0	24	27	34,4	10,0	62,7
WTRMF12G04	12	G1/2"	M22X1	12,0	24	27	39,4	15,0	62,3

**WTRMF-N**

Bulkhead female connector NPT thread nickel plated

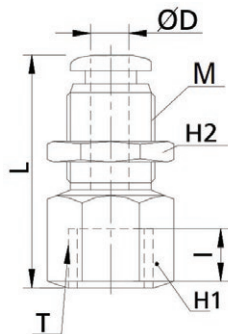

CODE	ØD	T	M	I	H1	H2	L	LB
WTRMF532N01	5/32	N1/8"	M12X1	0,295	0,562	0,562	0,937	0,034
WTRMF316N02	3/16	N1/4"	M14X1	0,413	0,685	0,685	1,196	0,055
WTRMF1-4N01	1/4	N1/8"	M14X1	0,295	0,685	0,685	0,972	0,057
WTRMF1-4N02	1/4	N1/4"	M14X1	0,413	0,685	0,685	1,196	0,058
WTRMF516N01	5/16	N1/8"	M16X1	0,295	0,685	0,748	1,098	0,070
WTRMF516N02	5/16	N1/4"	M16X1	0,413	0,748	0,748	1,413	0,093
WTRMF516N03	5/16	N3/8"	M16X1	0,433	0,748	0,748	1,393	0,093
WTRMF38N02	3/8	N1/4"	M20X1	0,413	0,874	0,874	1,255	0,117
WTRMF38N03	3/8	N3/8"	M20X1	0,0433	0,874	0,874	1,366	0,118
WTRMF1-2N03	1/2	N3/8"	M22X1	0,433	1	1	1,393	0,138
WTRMF1-2N04	1/2	N1/2"	M22X1	0,551	1	1	1,629	0,137

