



from -20°C to +200°C



16 Bar



Male threads taper  
BSPT R1/8" to R2"  
Female threads parallel BSPP  
from G1/8" to G2"



Stainless steel AISI 316 microcast

**FEATURES**

Pressure for intermediate temperatures may be determined by interpolation method. Temperatures indicated are related to the internal fluid flow. External piping loads, stress and moments over external walls are not taken in consideration.



Products in compliance with the directive 2002/95/EC

**RoHS2**

Products in compliance with the directive 2011/65/EU

**1410MF**

Nipple connector

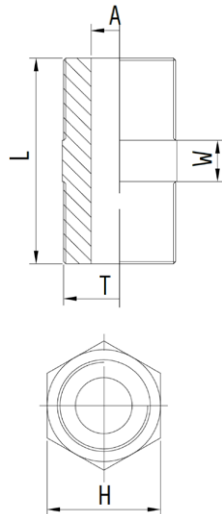

CODE	T	L	A	W	H
1410MF18	R1/8"	20,0	5,5	4,0	11,0
1410MF14	R1/4"	25,0	9,0	4,0	15,0
1410MF38	R3/8"	27,0	11,5	5,0	19,0
1410MF12	R1/2"	34,0	15,0	5,0	23,0
1410MF34	R3/4"	36,5	20,5	5,5	28,0
1410MF1	R1"	42,0	26,0	6,0	34,0
1410MF114	R1-1/4"	47,5	34,5	6,5	44,0
1410MF112	R1-1/2"	47,5	40,0	6,5	50,0
1410MF2	R2"	57,0	51,0	7,0	62,0

